

## 90° PE 100 BEND SDR 17 FOR SPEILSVEISING



### PRODUKTBEKRIVELSE

PE 100 sprøytetøppte bend

90°

SDR 17

For speilsveising

Har korte rettender og skal derfor kun speilsveises.

355 mm og 400 mm leveres på forespørsel.

### MÅLSKISSE

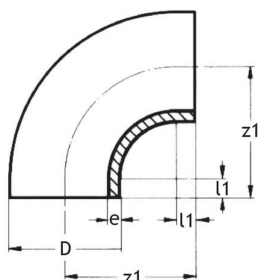

NRF-nr	D	z1	e	l1	Datablad
2450086	50 mm	51 mm	3 mm	10 mm	<a href="#">9010459268112</a>
2450088	63 mm	66 mm	3,8 mm	12 mm	<a href="#">9010459101235</a>
2450091	75 mm	87 mm	4,5 mm	14 mm	<a href="#">9010459101228</a>
2450093	90 mm	100 mm	5,4 mm	15 mm	<a href="#">9010459101204</a>
2450095	110 mm	118 mm	6,6 mm	15 mm	<a href="#">9010459101181</a>
2450097	125 mm	138 mm	7,4 mm	15 mm	<a href="#">9010459101174</a>
2450099	140 mm	155 mm	8,3 mm	20 mm	<a href="#">9010459101167</a>
2450102	160 mm	178 mm	9,5 mm	25 mm	<a href="#">9010459101150</a>
2450104	180 mm	195 mm	10,7 mm	25 mm	<a href="#">9010459101143</a>
2450106	200 mm	210 mm	11,9 mm	20 mm	<a href="#">9010459101136</a>
2450108	225 mm	236 mm	13,4 mm	25 mm	<a href="#">9010459101129</a>
2450111	250 mm	279 mm	14,8 mm	30 mm	<a href="#">9010459101112</a>
2450113	280 mm	316 mm	16,6 mm	40 mm	<a href="#">9010459101105</a>

### PIPELIFE NORGE AS

6650 Surnadal / Norge

Telefon: +47 71 65 88 00 · Org.nr. 980 457 575

E-post: [firmapost@pipelife.com](mailto:firmapost@pipelife.com)



---

NRF-nr	D	z1	e	l1	Datablad
2450115	315 mm	352 mm	18,7 mm	40 mm	<a href="#">9010459101099</a>