

RURA PE100RC PN10 SDR 17

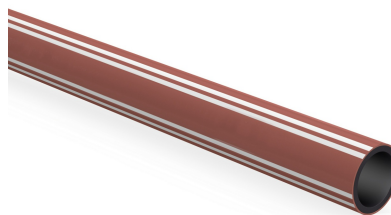

RYSUNEK TECHNICZNY

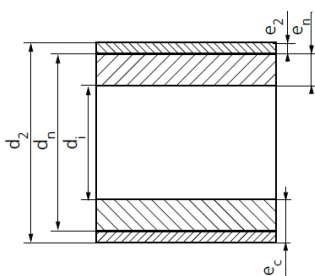

| Indeks SAP | Opis SAP | Jedn. |
|------------|---|-------|
| 3497102768 | PE100RC-PE 17 90/5.4/12 PN10 CZBR AQUALINE ROBUST | SZT |
| 3497102769 | PE100RC-PE 17 110/6.6/12 PN10 CZBR AQUALINE ROBUST | SZT |
| 3497102770 | PE100RC-PE 17 125/7.4/12 PN10 CZBR AQUALINE ROBUST | SZT |
| 3497102771 | PE100RC-PE 17 140/8.3/12 PN10 CZBR AQUALINE ROBUST | SZT |
| 3497102772 | PE100RC-PE 17 160/9.5/12 PN10 CZBR AQUALINE ROBUST | SZT |
| 3497102773 | PE100RC-PE 17 180/10.7/12 PN10 CZBR AQUALINE ROBUST | SZT |
| 3497102774 | PE100RC-PE 17 200/11.9/12 PN10 CZBR AQUALINE ROBUST | SZT |
| 3497102775 | PE100RC-PE 17 225/13.4/12 PN10 CZBR AQUALINE ROBUST | SZT |
| 3497102776 | PE100RC-PE 17 250/14.8/12 PN10 CZBR AQUALINE ROBUST | SZT |